

NOTES:

1. ALL CONCRETE SHALL BE AIR ENTRAINED, 4000 PSI.
2. ALL JOINTS WITH EXISTING CURB SHALL BE TYPE #2 JOINTS.
3. A TYPE #2 JOINT SHALL BE PLACED AT ALL CURB RETURNS, P.C.'S, P.T.'S AND TRANSITIONS, AND WHERE NEW CURB OR PAVEMENT TIES INTO EXISTING CURB. TYPE #2 SMOOTH BARS SHALL BE 24" LONG.
4. A TYPE #1 JOINT SHALL BE PLACED AT 15' O.C. TYPE #1 JOINTS MAY BE CONSTRUCTED WITH A GROOVING TOOL OR WITH A CONCRETE SAW AFTER THE CONCRETE IS SET.
5. AB-3 MAY BE USED AS A LEVELING COURSE TO BRING SUBGRADE TO PROPER ELEVATION (6" max.).
6. DURING DRY CURB TRANSITIONS, WATER SHALL FLOW FROM THE GUTTER TO THE LIP @ 0.5% min. SLOPE.

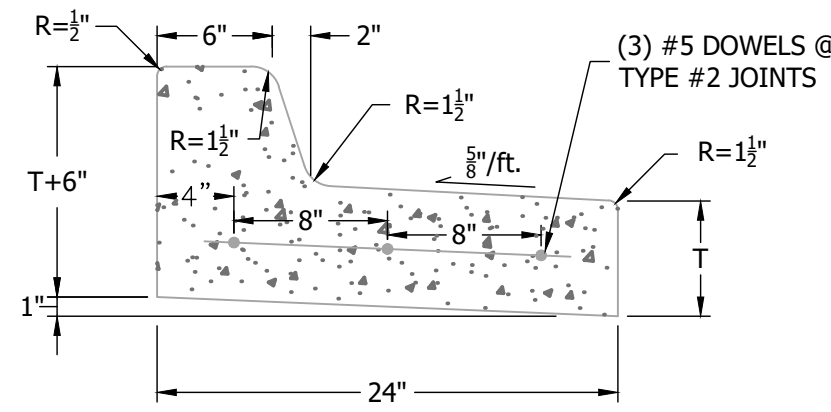

001B - "DRY" P.C.C. CURB AND GUTTER

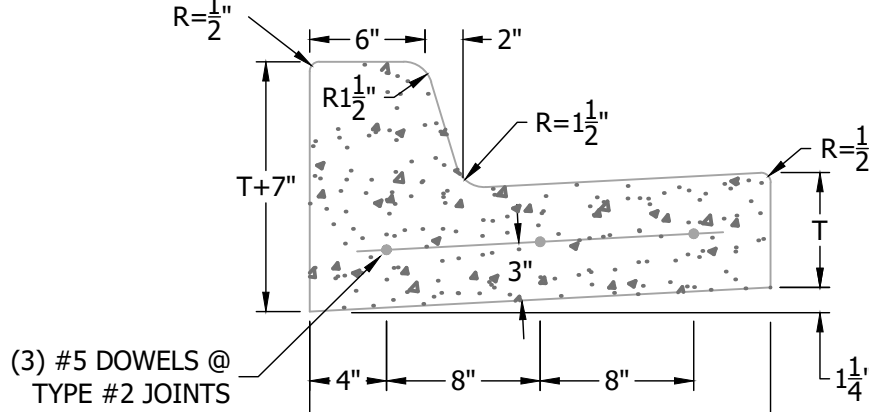

001A - "WET" P.C.C. CURB AND GUTTER

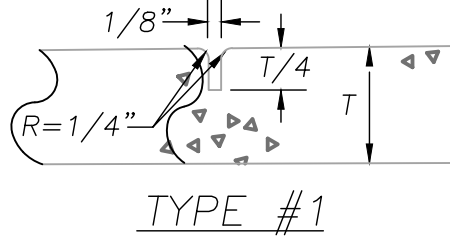

TYPE #1

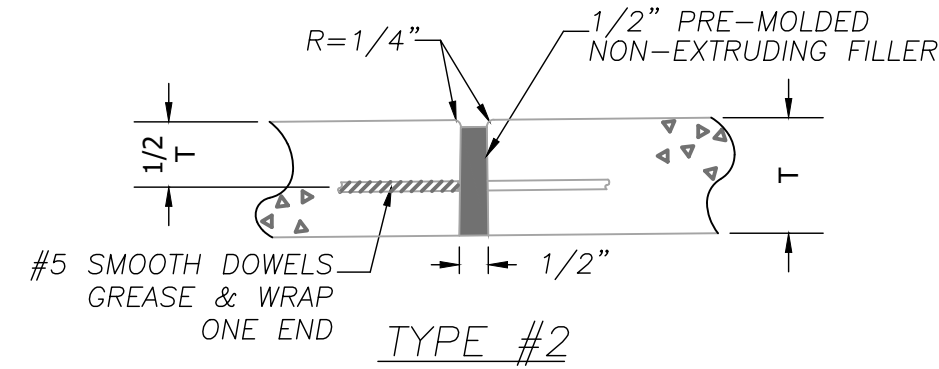

TYPE #2

Concrete Curb & Gutter
Not to Scale

NOTES:

1. CONTROL JOINT SPACING SHALL MATCH WIDTH OF SIDEWALK/DRIVE.
2. ISOLATION JOINTS SHALL BE PLACED @ 250' CENTERS OR WHERE WALKS ABUT CURBS, BUILDINGS, ETC.
3. ALL EXTERIOR CONCRETE SHALL HAVE A BROOM FINISH.
4. TRASH PAD, HEAVY DUTY PAVEMENT, TO HAVE 8" THICK PCC.
5. KDOT 3500 PSI AT 28 DAYS, 4-INCH MAXIMUM SLUMP AND 5%-7% AIR ENTRAINED, MIX.

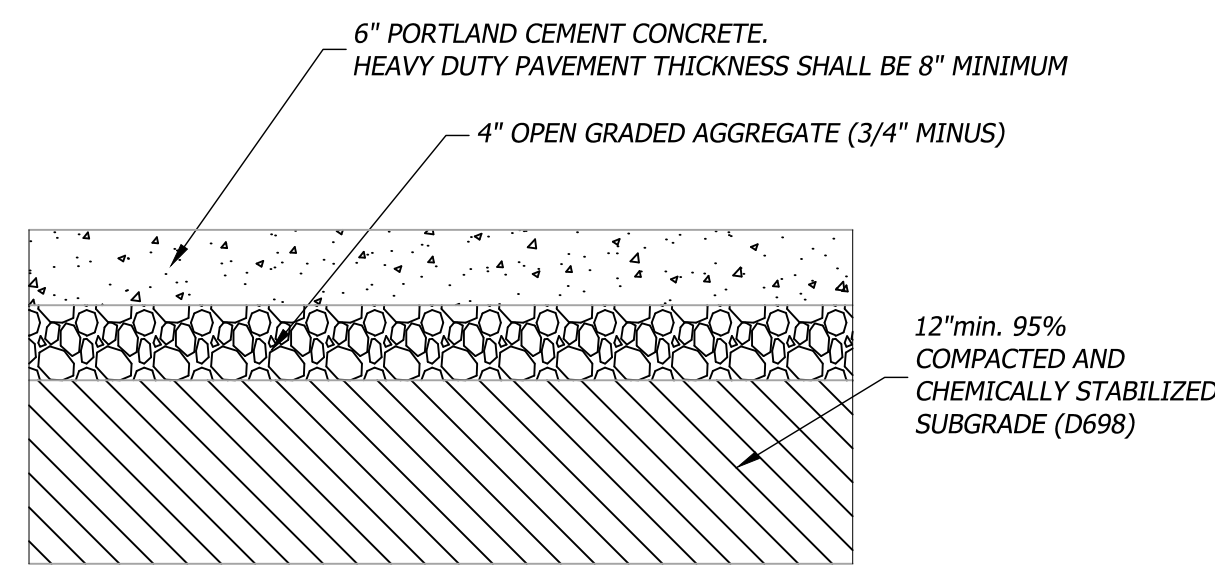

Concrete Pavement

NOTES:

1. SHOP DRAWINGS FOR ASPHALT SHALL BE SUBMITTED PRIOR TO BATCHING. DENSITY TESTING FOR ASPHALT SHALL BE AT A MINIMUM OF 3 PER LIFT PER DAY DURING THE ASPHALT LAYING OPERATION. FINAL THICKNESS OF ASPHALT SHALL BE MEASURED AT 3 RANDOM LOCATIONS WITHIN THE SITE BY CORING THE PAVEMENT. THE AVERAGE OF THESE 3 CORES MUST BE GREATER THAN THE MINIMUM THICKNESS SPECIFIED IN THE PLANS.
2. ASPHALT PAVEMENT CONSTRUCTION SHALL ONLY COMMENCE WHEN AMBIENT TEMPERATURE IS 32 DEGREES FAHRENHEIT AND RISING.
3. THICKNESS SHOWN AS MINIMUM. SEE SHEET C1.0 FOR LOCATIONS OF LIGHT AND MEDIUM DUTY SECTIONS

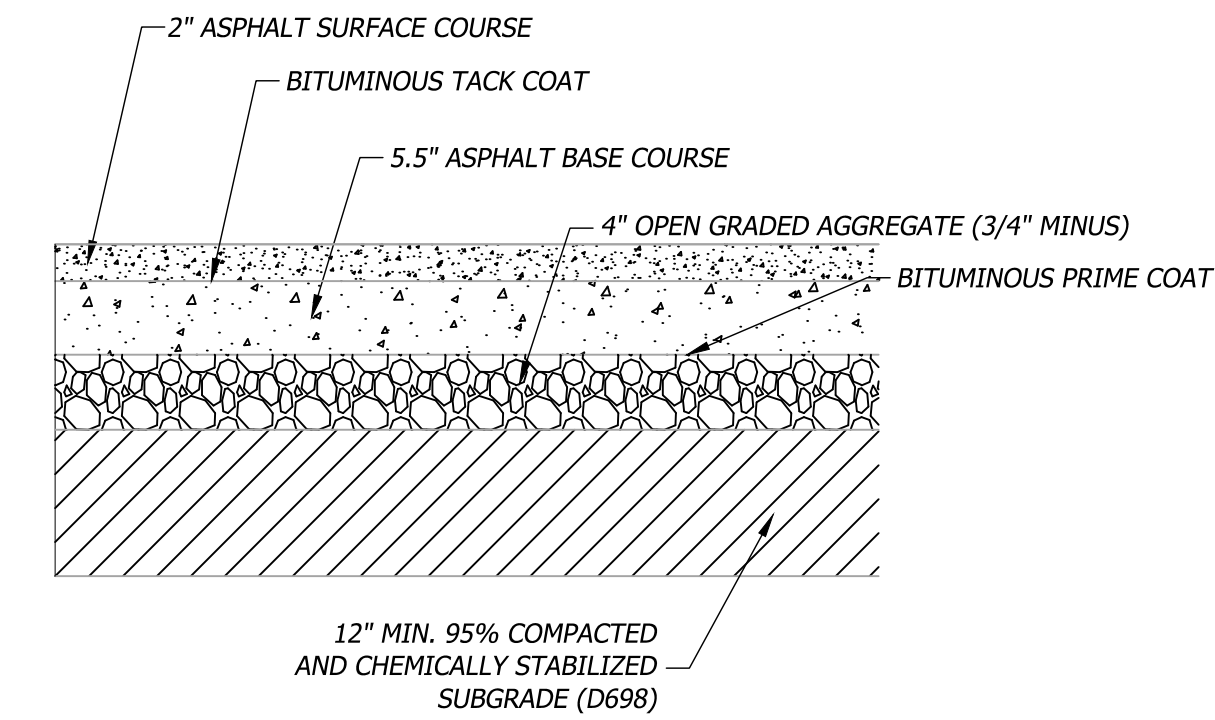

Asphalt Pavement

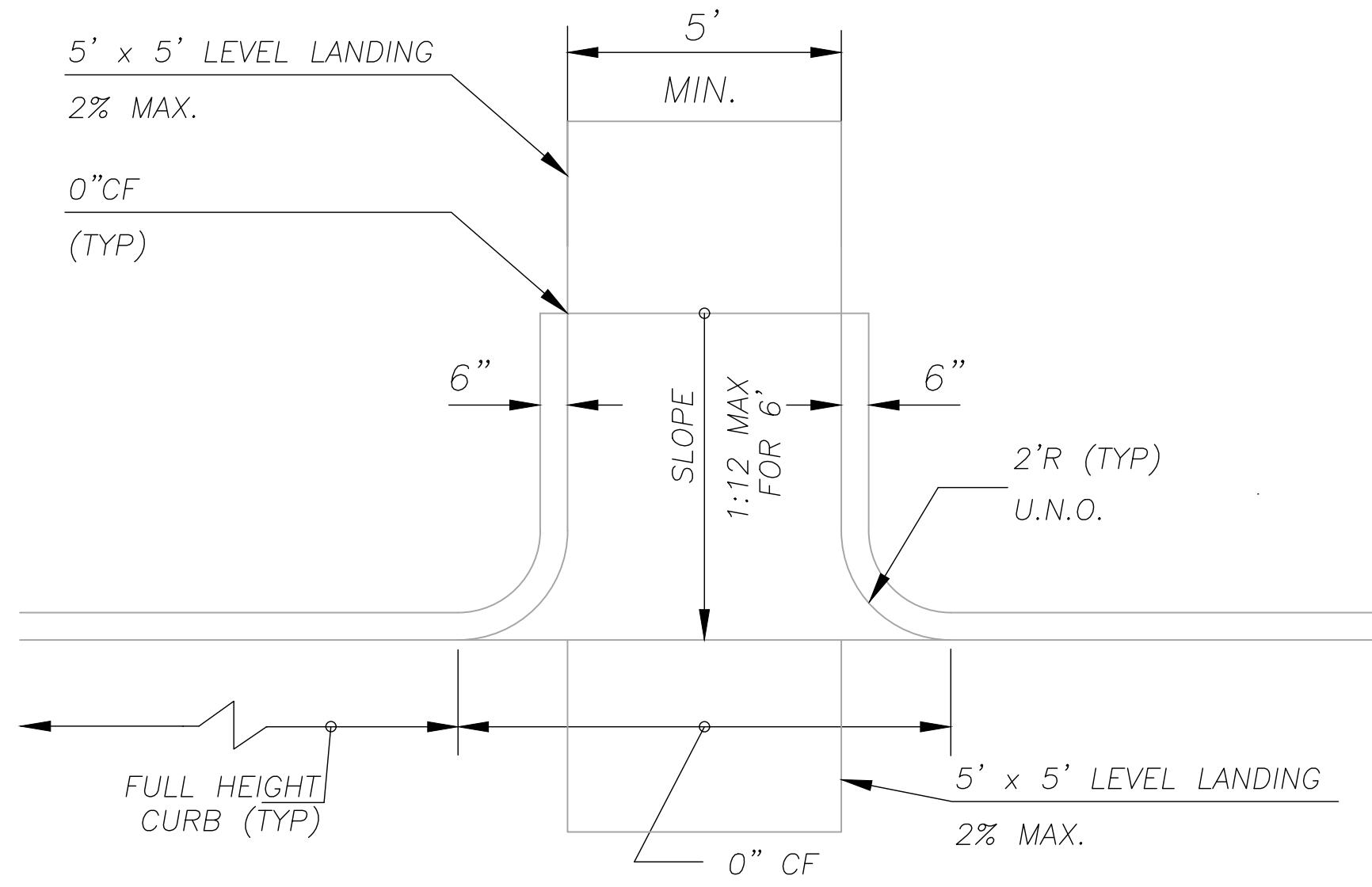

Type "A" Sidewalk Ramp
Not to Scale

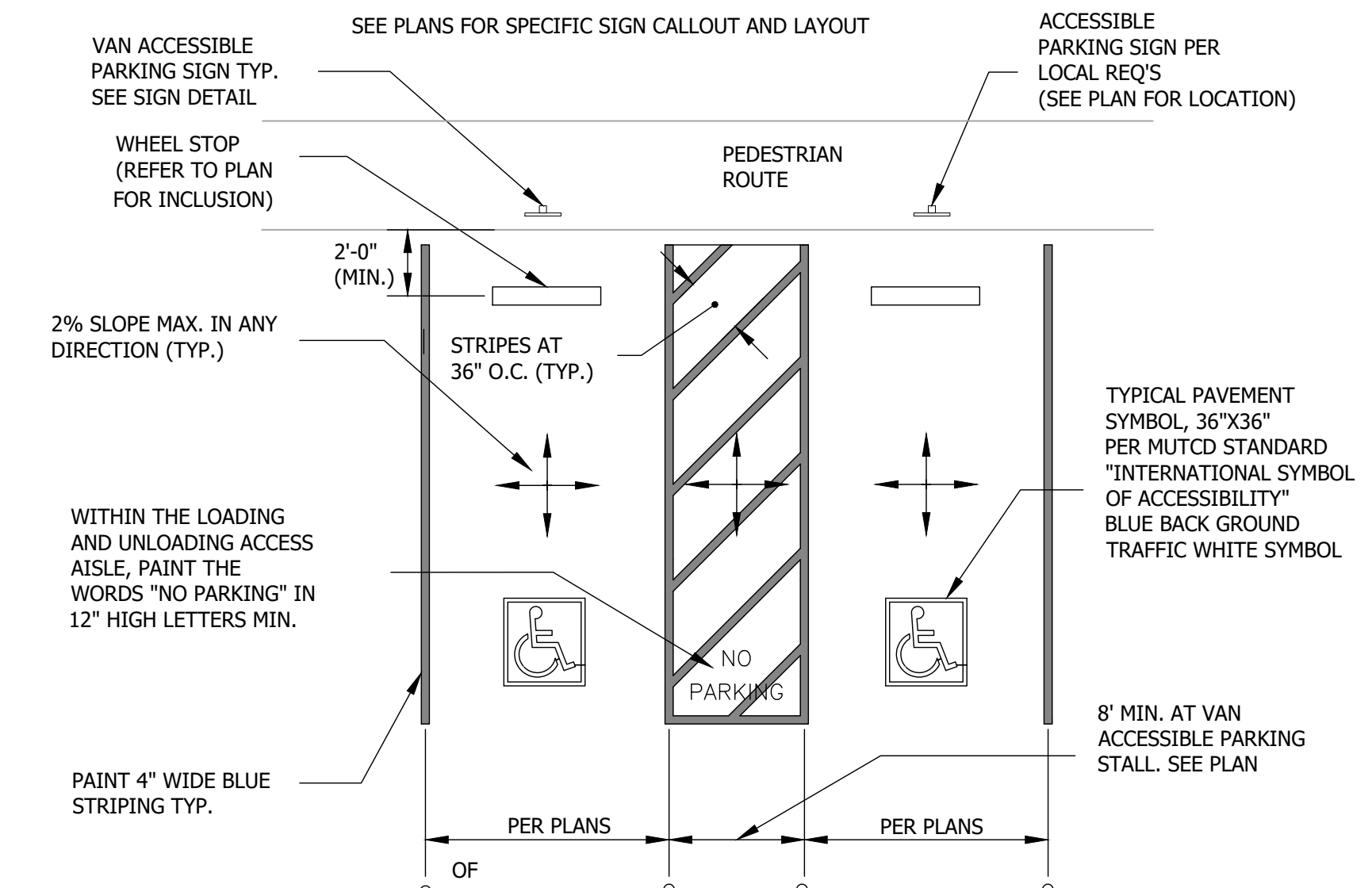

(ADA) Accessible Parking Striping
Not to Scale

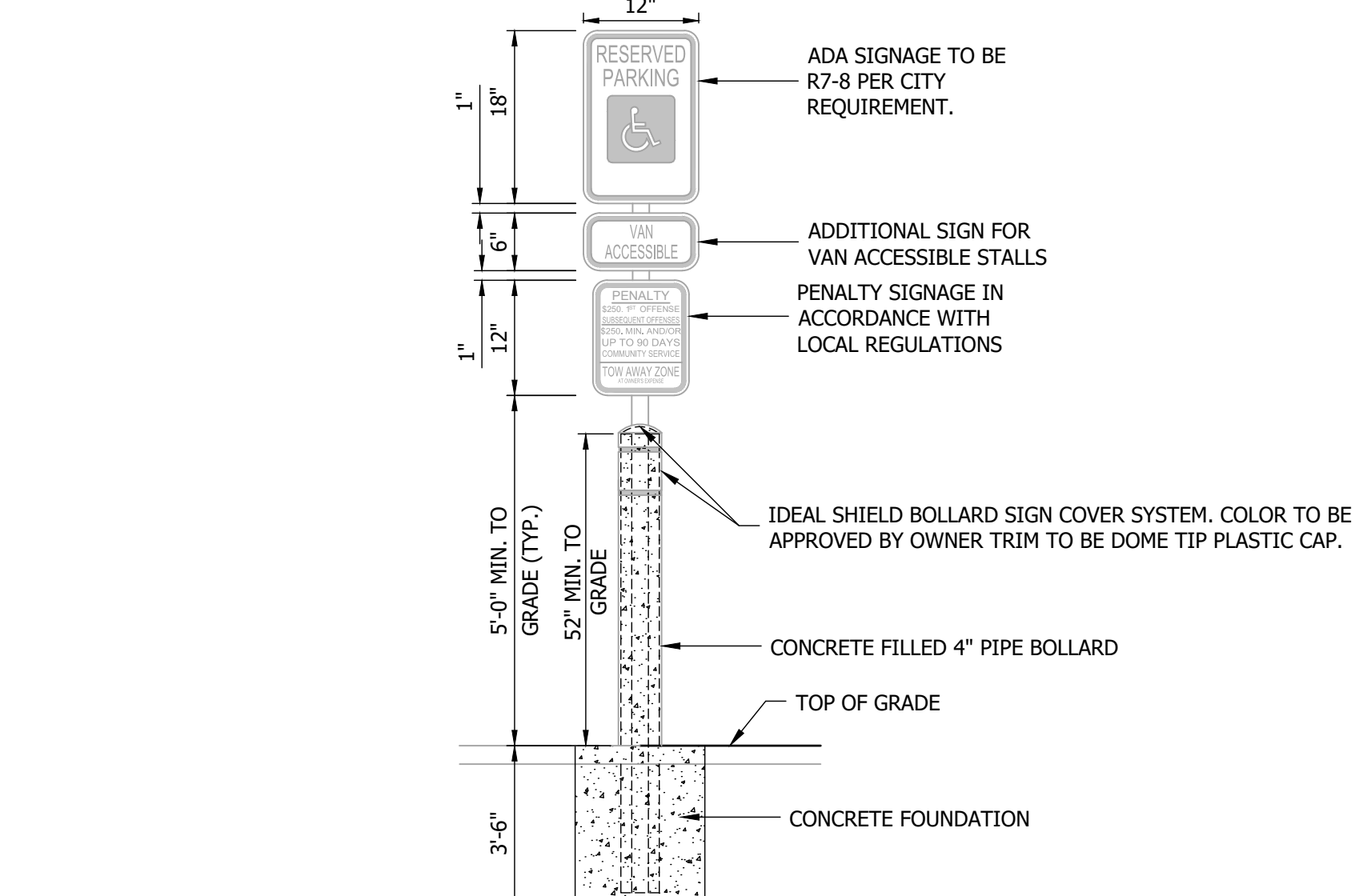

(ADA) Accessible Parking Signage
Not to Scale

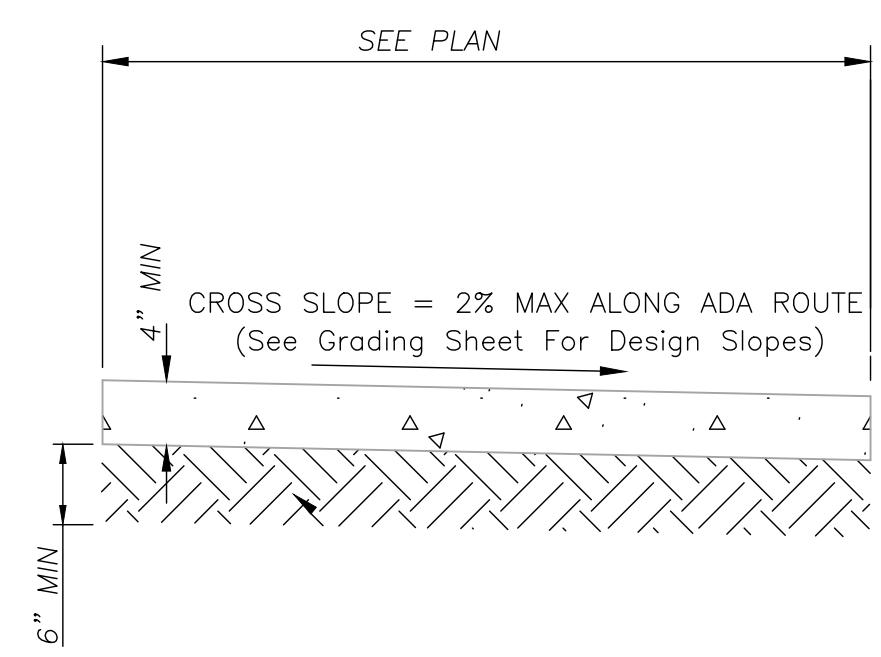

- NOTE:**
1. CONCRETE TO BE AIR ENTRAINED, 4000 PSI CONCRETE
 2. SUBGRADE TO BE MOISTURE CONDITIONED AND COMPACTED TO 95% MAX DENSITY PER ASTM D698
 3. CONTRACTION JOINTS TO BE INSTALLED AT A LONGITUDINAL SPACING EQUAL TO THE SIDEWALK WIDTH, BUT NOT TO EXCEED 6'. CONTRACTION JOINTS SHALL BE TO A DEPTH EQUAL TO 1/4 OF THE SIDEWALK THICKNESS
 4. EXPANSION JOINTS SHALL BE INSTALLED WHEN SIDEWALK ABUTS OR CONNECTS TO EXISTING STRUCTURES, SIDEWALKS, CURB & GUTTER AND AT LONGITUDINAL SPACING NOT TO EXCEED 100'
 5. ALL JOINTS ALONG THE ACCESSIBLE ROUTE SHALL BE OF A WIDTH NOT TO EXCEED 1/4"

Concrete Sidewalk Section
Not to Scale

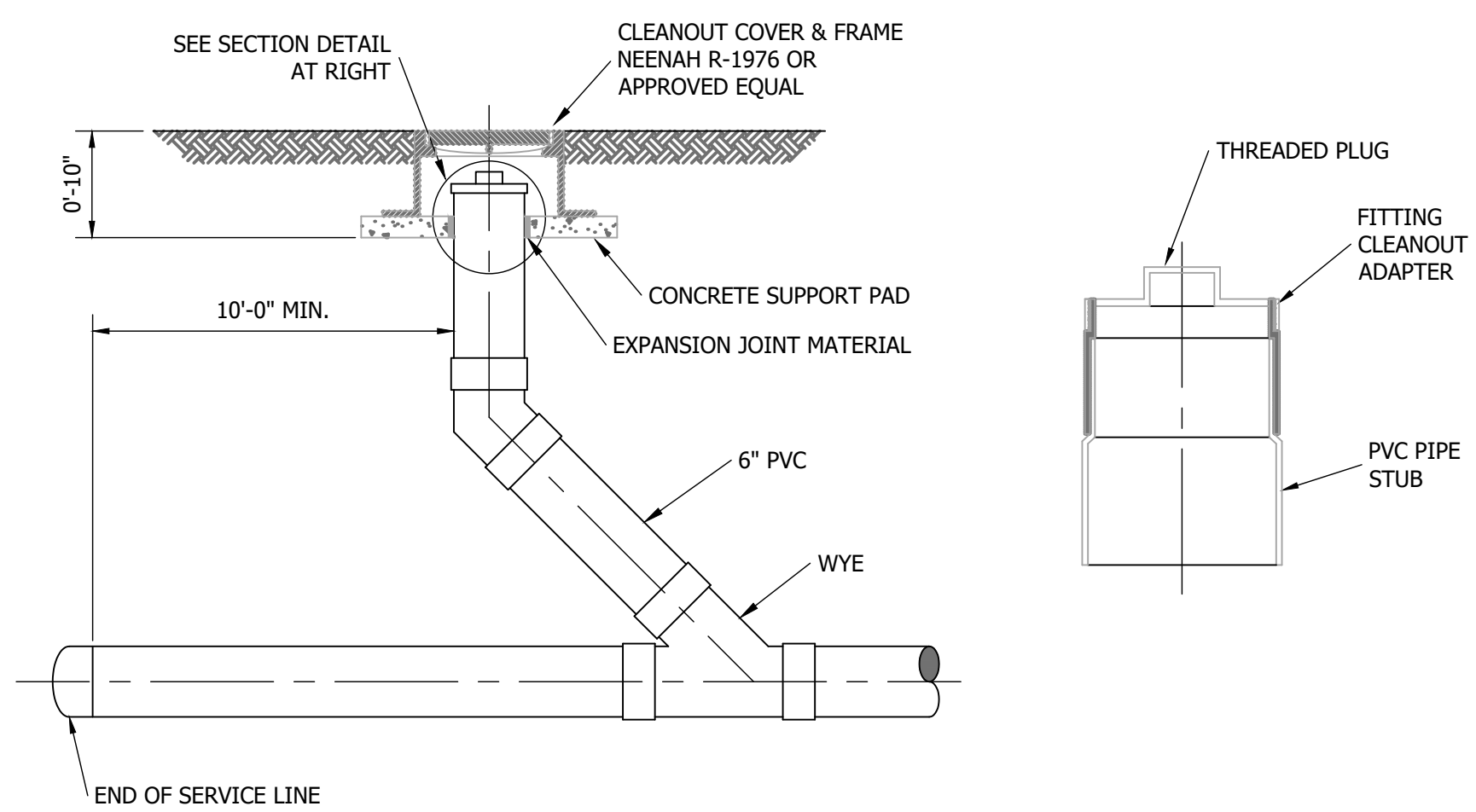

Sanitary Sewer Cleanout
Not to Scale

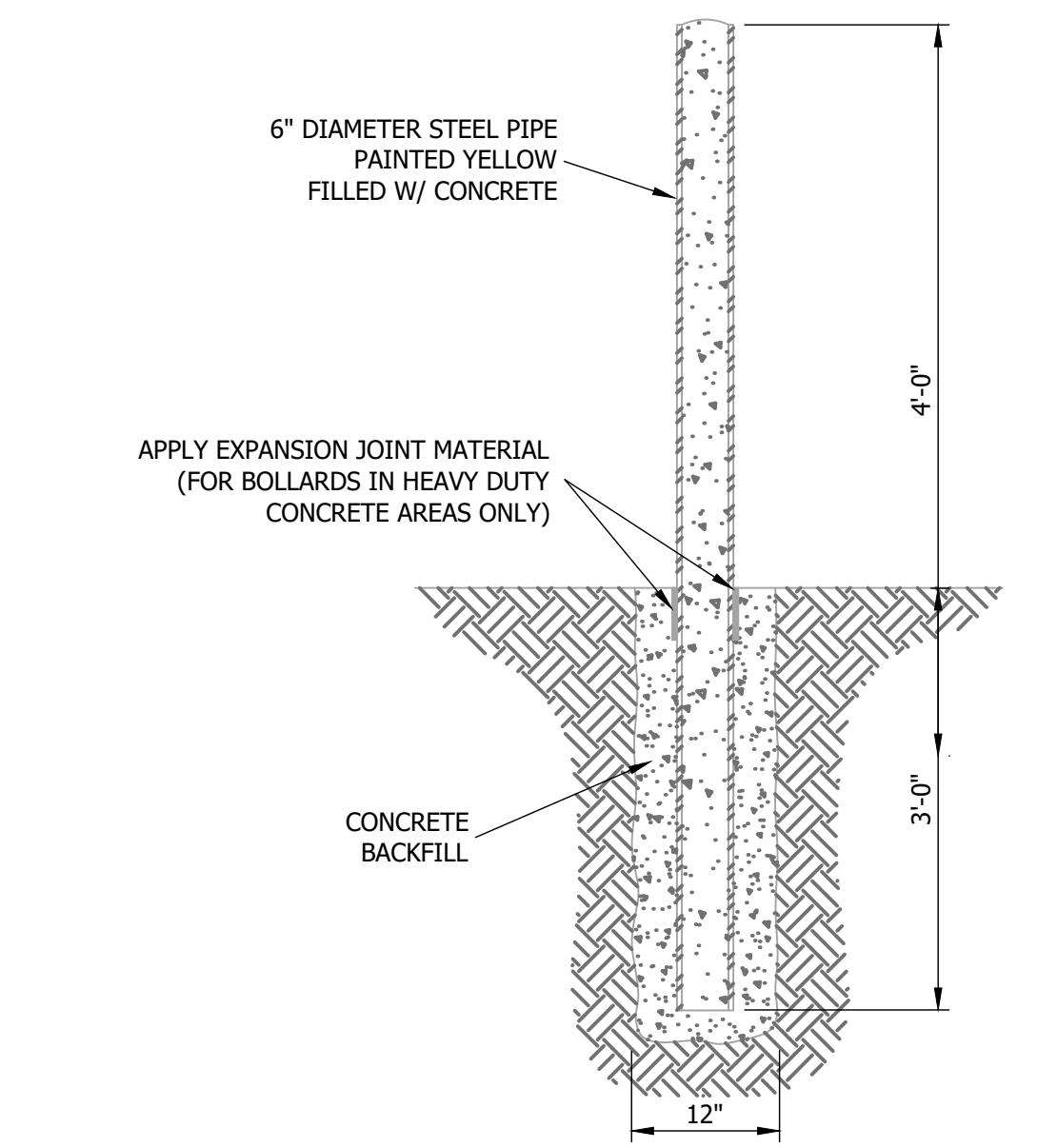

Steel/Concrete Bollard
Not to Scale

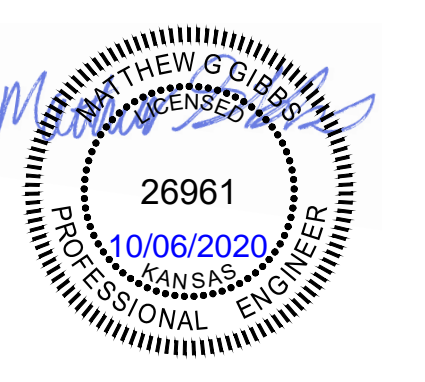

18048.20003

CONTRACT DATE: XX.XX.XX
BUILDING TYPE: END_MED40
PLAN VERSION: MARCH 2020
BRAND DESIGNER: X.XXXXX
SITE NUMBER: 314443
STORE NUMBER: XXXXX

TACO BELL
615 METROPOLITAN AVE
LEAVENWORTH, KS

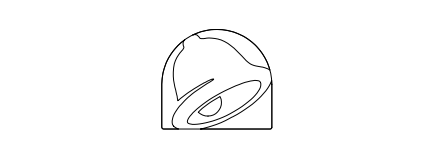

ENDEAVOR 1.0
MED 40

CIVIL DETAILS 1

C6.1

BHC RHODES
Civil Engineering • Surveying • Utilities
7101 College Blvd., Suite 400
Overland Park, Kansas 66210
p. (913) 663-1900 f. (913) 663-1633
BHC RHODES is a trademark of Brunner, Nason & Company, P.A.