

W:\Shared\Clients\McDonalds\Survey and PZP\Market_Heartland\024-0051 (01916) BkST\024-0051 (01916) CAD\Current\024-0051 (01916) BKST.dwg September 30, 2019 10:31am (GETVAR,??)

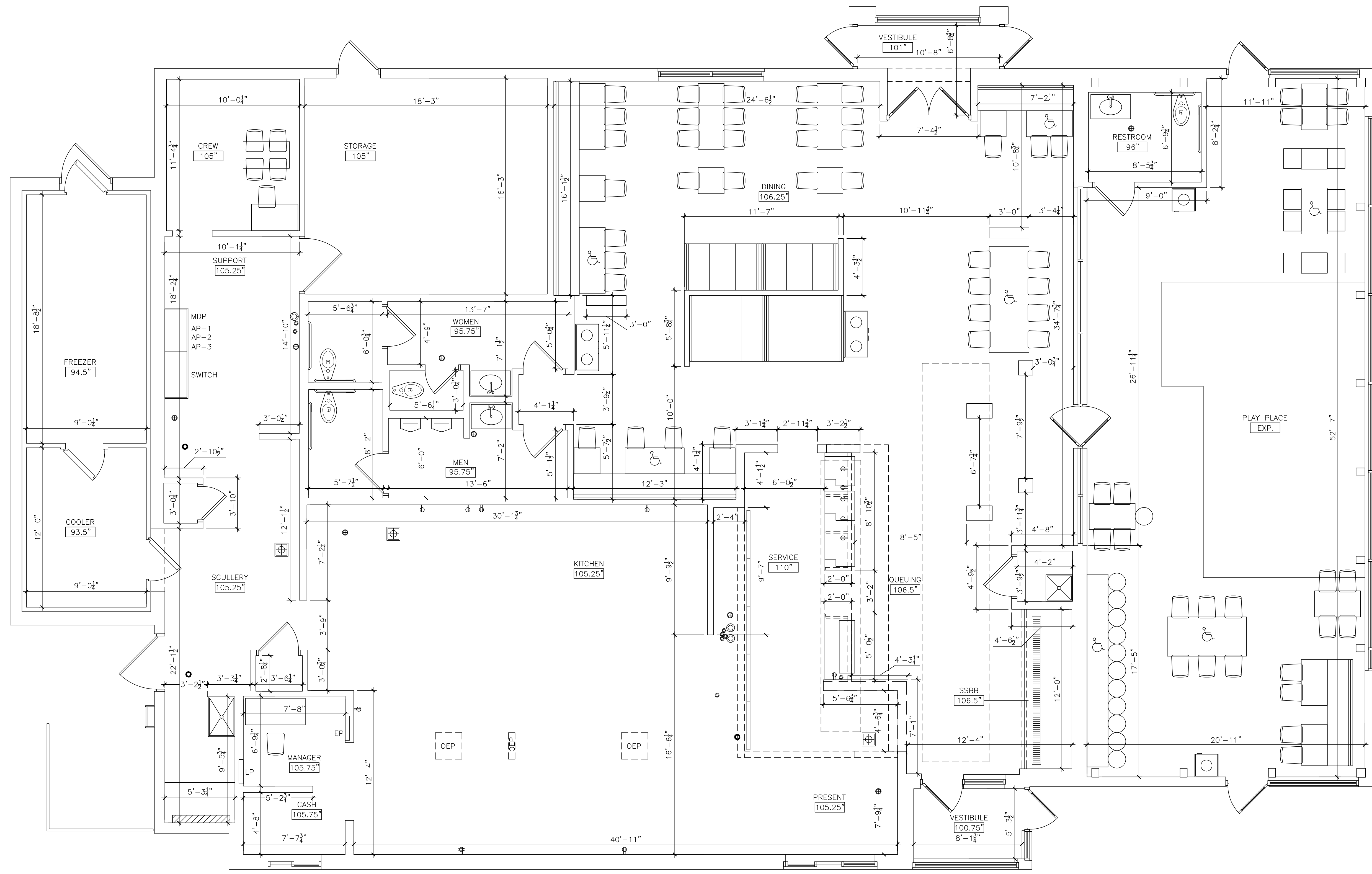

1 EXISTING FLOOR PLAN - LEVEL 1
 SCALE: 1/4" = 1'-0"
 TOTAL SQ FT = 5,781
 TOTAL SEATING = 106

sevan
 MULTI-SITE SOLUTIONS
 DESIGN LLC.
 Regional Office:
 37704 Hills Tech Drive
 Farmington Hills, MI 48331
 Telephone: 734-307-4445
 Corporate Office:
 4925 Forest Avenue
 Downers Grove, IL 60515
 info@sevan.com www.sevan.com

SAFETY - INTEGRITY - SUSTAINABILITY

REVISIONS	
NO.	DESCRIPTION

SEAL

SEAL NOTE

PREPARED FOR
McDonald's USA LLC
 These drawings and specifications are the confidential and proprietary property of McDonald's USA, LLC and shall not be copied or reproduced without written authorization. The contract documents were prepared for use on this specific site in conjunction with its issue date and are not suitable for use on a different site or at a later time. Use of these drawings for reference or example on another project requires the services of properly licensed architects and engineers. Reproduction of the contract documents for reuse on another project is not authorized.

PROJECT DESCRIPTION
EXISTING CONDITIONS

PROJECT LOCATION
McDonald's
7887 STATE LINE RD
KANSAS CITY, MO
64114-1636

SHEET TITLE
FLOOR PLAN

SHEET MANAGEMENT
 PROJECT NO.: 024-0051
 DATE ISSUED: 09/18/2019
 DRAWN BY: JLD
 REVIEWED BY: TF

NATIONAL STORE #
01916

SHEET NUMBER
A1.0
 EX. FLOOR PLAN

Submital Type - AS-BUILT

W:\Shared\Clients\McDonalds\Survey and P2P\Market_Heartland\024-0051 (01916)_BkST\024-0051 (01916)_CAD\Current\024-0051 (01916)_BkST.dwg September 30, 2019 10:31am \$(GETVAR,??)

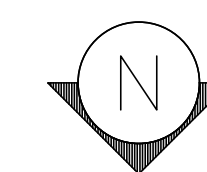
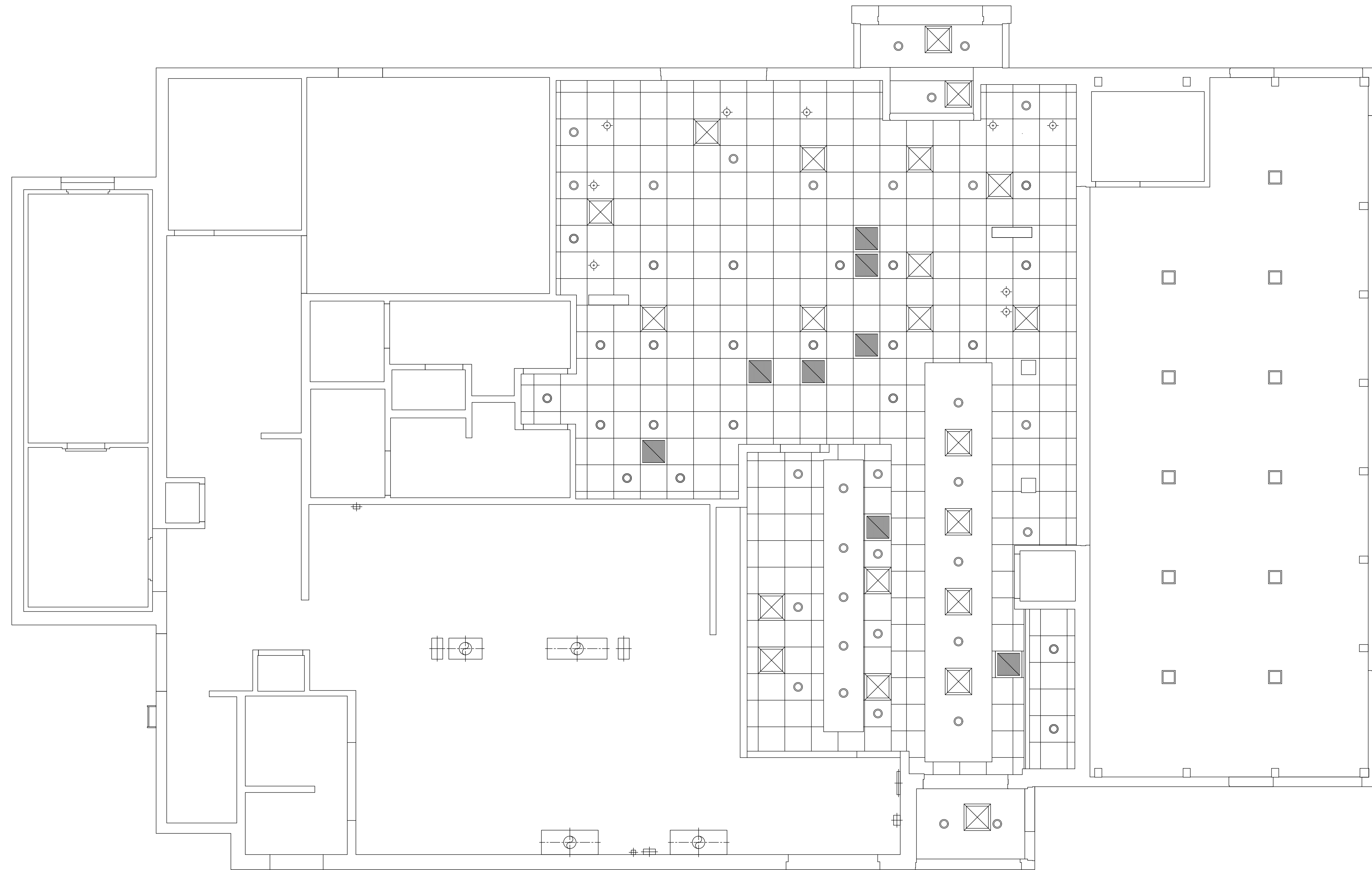

1 EXISTING REFLECTED CEILING PLAN
 A1.1 SCALE: 1/4" = 1'-0"

sevan
 MULTI-SITE SOLUTIONS
 DESIGN LLC.

Regional Office:
 37704 Hills Tech Drive
 Farmington Hills, MI 48331
 Telephone: 734-307-4465

Corporate Office:
 4925 Forest Avenue
 Downers Grove, IL 60515
 info@sevensolutions.com www.sevensolutions.com

SAFETY - INTEGRITY - SUSTAINABILITY

REVISIONS		
NO.	DATE	DESCRIPTION
-	-	-
-	-	-
-	-	-
-	-	-
-	-	-
-	-	-
-	-	-

SEAL

SEAL NOTE

PREPARED FOR
McDonald's USA LLC

These drawings and specifications are the confidential and proprietary property of McDonald's USA, LLC and shall not be copied or reproduced without written authorization. The contract documents were prepared for use on this specific site in conjunction with its issue date and are not suitable for use on a different site or at a later time. Use of these drawings for reference or example on another project requires the services of properly licensed architects and engineers. Reproduction of the contract documents for reuse on another project is not authorized.

PROJECT DESCRIPTION
EXISTING REFLECTED CEILING PLAN

PROJECT LOCATION
**McDonald's
 7887 STATE LINE RD
 KANSAS CITY, MO
 64114-1636**

SHEET TITLE
REFLECTED CEILING PLAN

SHEET MANAGEMENT
 PROJECT NO.: 024-0051
 DATE ISSUED: 09/18/2019
 DRAWN BY: JLD
 REVIEWED BY: TF

NATIONAL STORE #
01916

SHEET NUMBER
A1.1
 EX. RCP

Submittal Type - AS-BUILT

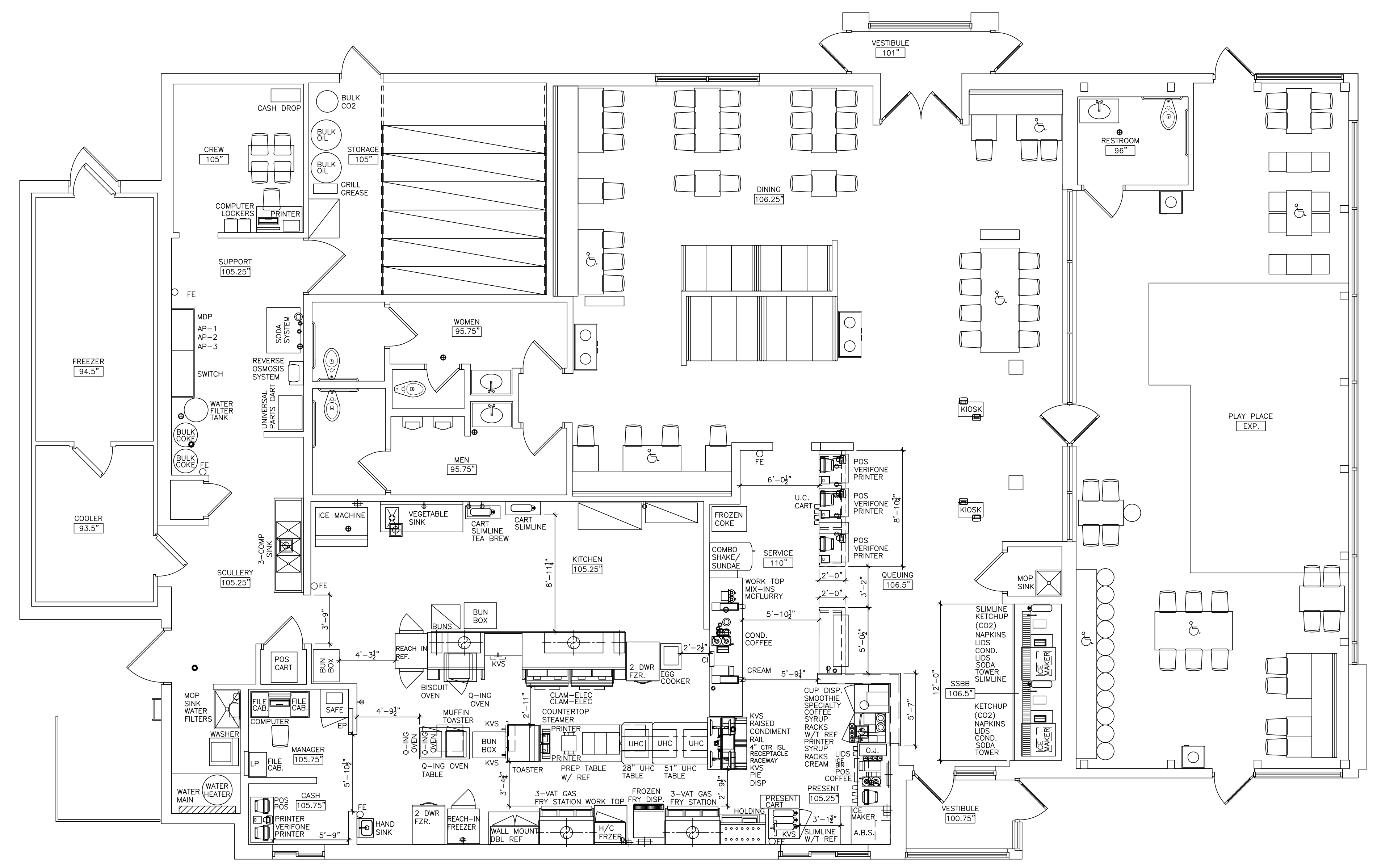

1 EXISTING EQUIPMENT PLAN
SCALE: 3/16" = 1'-0"

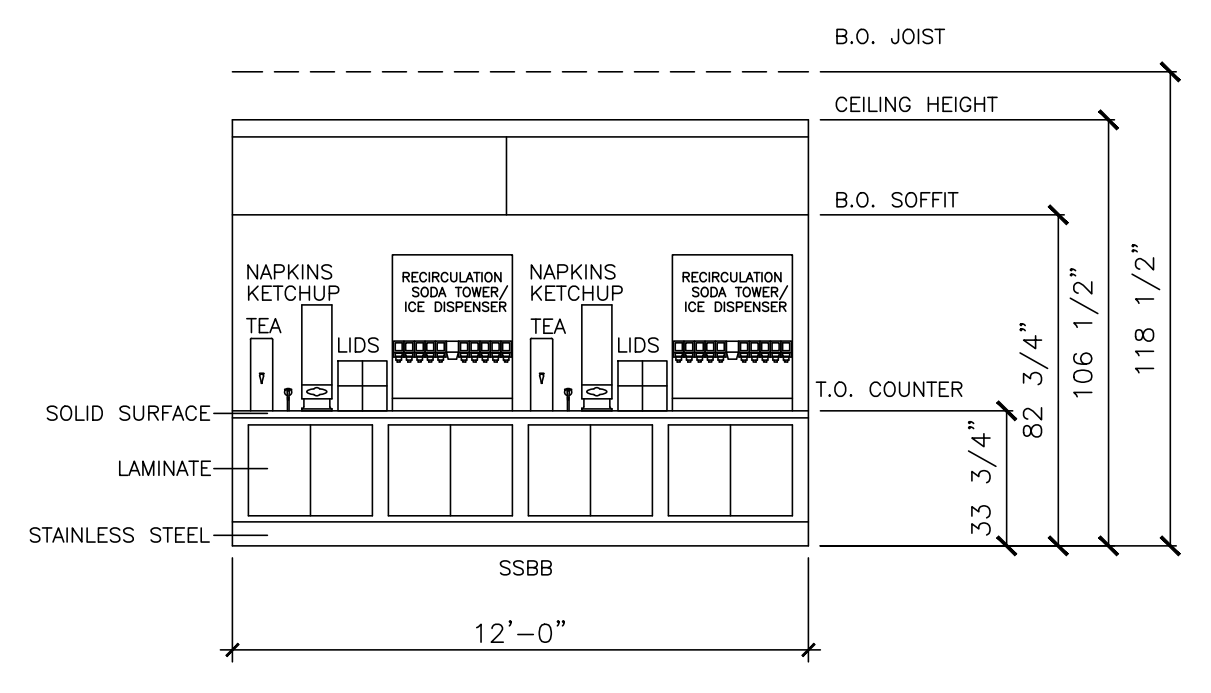

2 EXISTING SSBB COUNTER ELEVATION
SCALE: 1/4" = 1'-0"

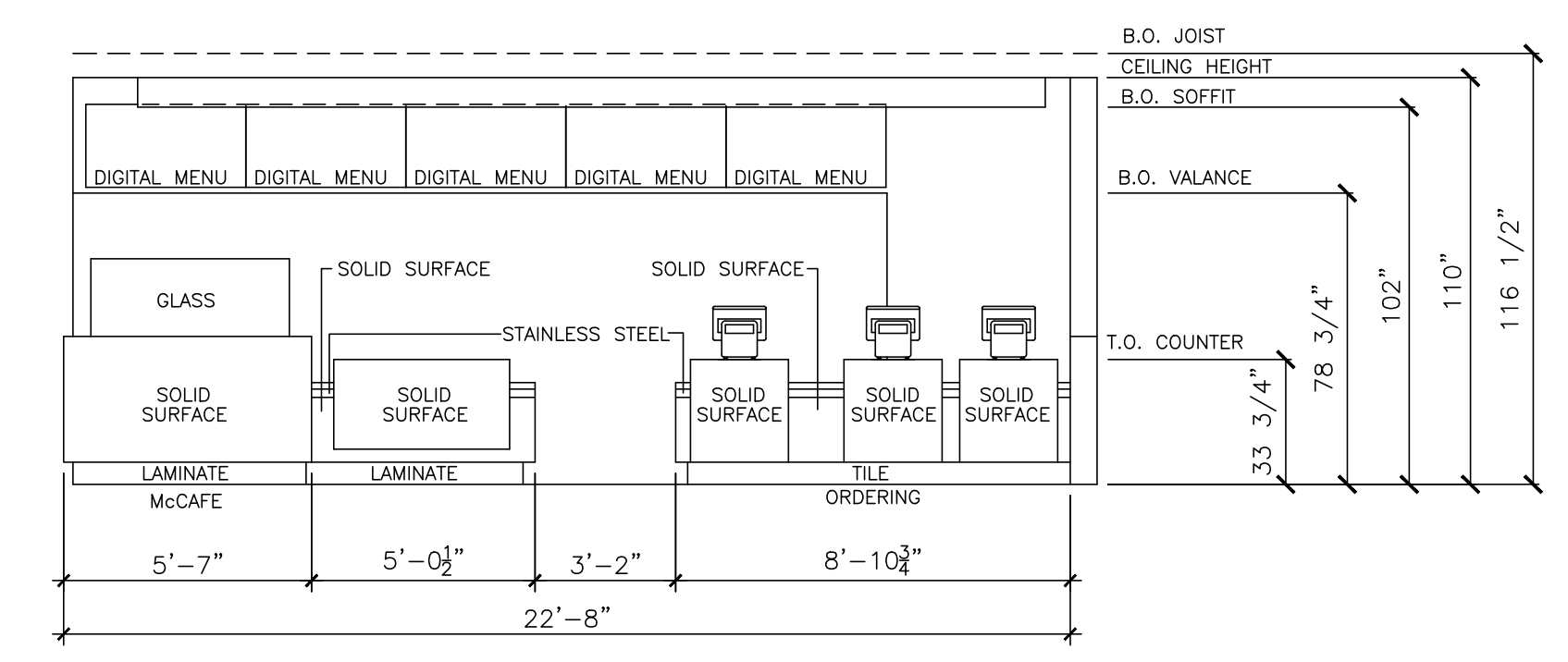

3 EXISTING FRONT COUNTER ELEVATION
SCALE: 1/4" = 1'-0"

REVISIONS

NO.	DATE	DESCRIPTION
-	-	-
-	-	-
-	-	-
-	-	-
-	-	-
-	-	-
-	-	-

SEAL

SEAL NOTE

PREPARED FOR
McDonald's USA LLC

These drawings and specifications are the confidential and proprietary property of McDonald's USA, LLC and shall not be copied or reproduced without written authorization. The contract documents were prepared for use on this specific site in conjunction with its issue date and are not suitable for use on a different site or at a later time. Use of these drawings for reference or example on another project requires the services of properly licensed architects and engineers. Reproduction of the contract documents for reuse on another project is not authorized.

PROJECT DESCRIPTION
EXISTING CONDITIONS

PROJECT LOCATION
**McDonald's
7887 STATE LINE RD
KANSAS CITY, MO
64114-1636**

SHEET TITLE
**KITCHEN
EQUIPMENT PLAN**

SHEET MANAGEMENT
PROJECT NO.: 024-0051
DATE ISSUED: 09/18/2019
DRAWN BY: JLD
REVIEWED BY: TF

NATIONAL STORE #
01916

SHEET NUMBER
K1.0
EX. EQUIPMENT PLAN