

BUILDING OFFICIAL  
 REVIEWED FOR COMPLIANCE WITH THE CITY CODE, ADOPTED BUILDING CODES, ZONING ORDINANCE AND DESIGN STANDARDS. THIS REVIEW AND APPROVAL DOES NOT RELIEVE THE DESIGNER OR HIS AGENTS OF ANY RESPONSIBILITY FOR COMPLIANCE WITH ALL APPLICABLE REQUIREMENTS, OR VERIFIABLE THE REQUIREMENTS OF OTHER JURISDICTIONS OR AGENCIES, UNLESS SPECIFICALLY NOTED OTHERWISE.

NOTES:  
 1. THE FOOTCANDLE LEVELS AS SHOWN ARE BASED ON THE FOLLOWING CRITERIA. ANY SUBSTITUTIONS IN SPECIFIED FIXTURES OR CHANGES TO LAYOUT WILL AFFECT LIGHTING LEVELS SHOWN AND WILL NOT BE THE RESPONSIBILITY OF SECURITY LIGHTING.  
 2. DISTANCE BETWEEN READINGS \_\_\_\_\_ 10'

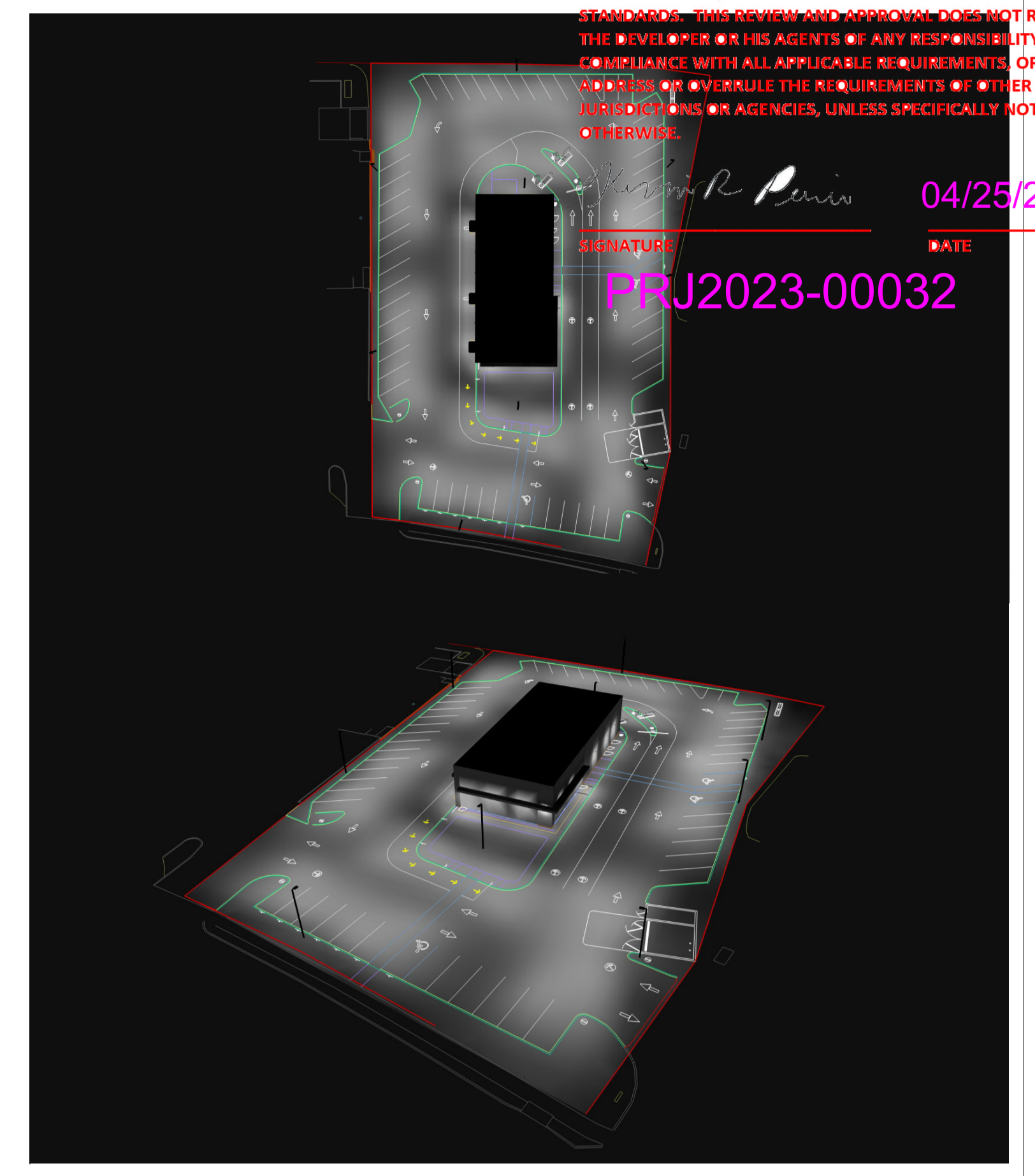
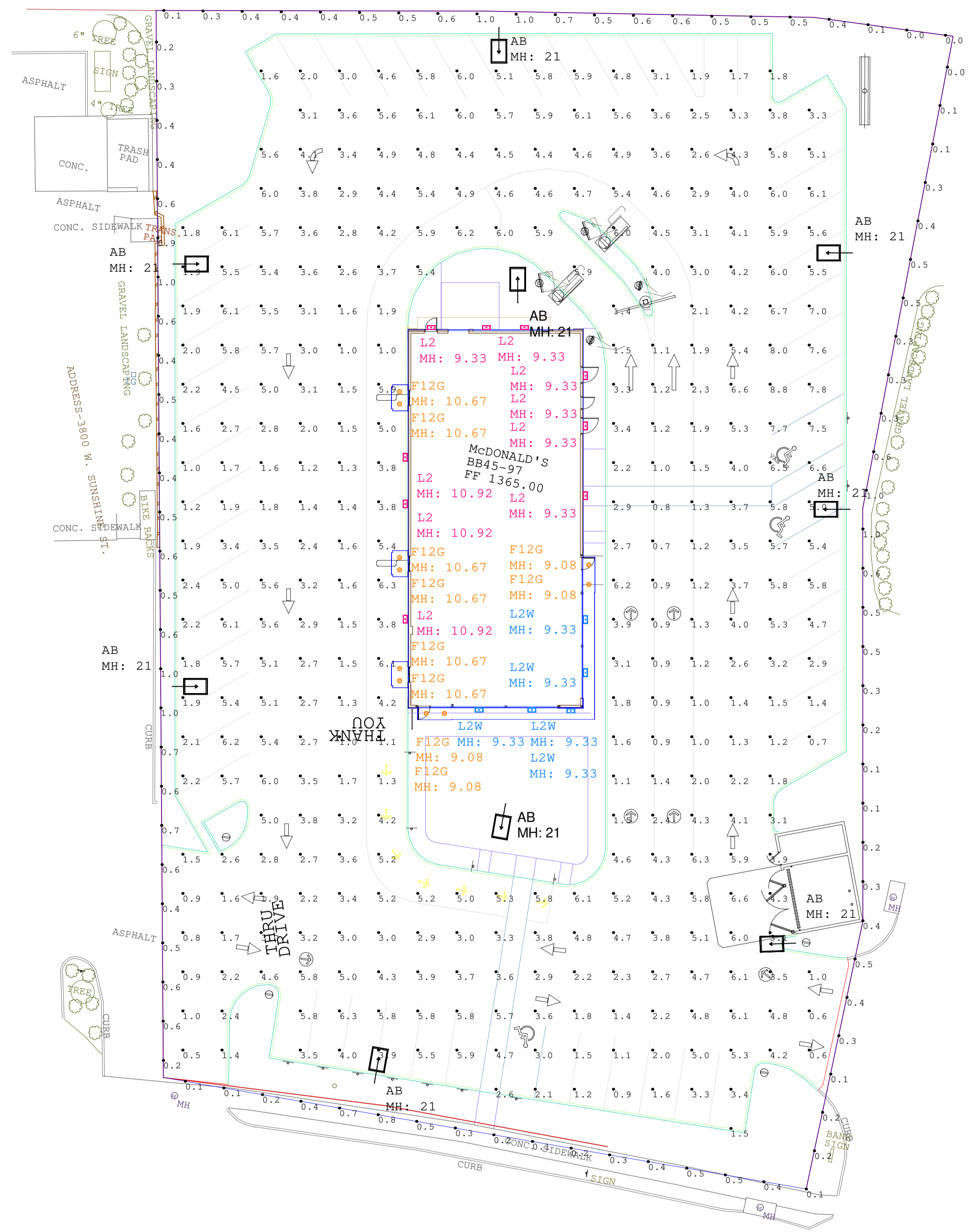

SIGNATURE: *Matthew R. Perin*  
 DATE: 04/25/23  
 PRJ2023-00032

Pole Fixtures Are Full Cutoff  
 Tilt=0  
 Calculation Grids Are At Grade  
 Pole Light Mounting Height=21ft  
 (18' Pole + 3' Base)

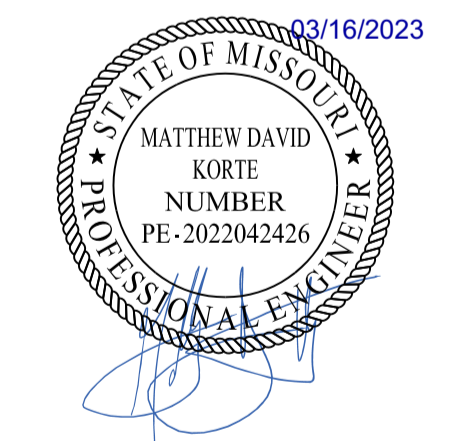

PROJECT WIND LOAD CRITERIA BASED ON:  
 ASCE 7-10 WIND SPEEDS (3-SEC PEAK GUST MPH)  
 50 YEAR MEAN RECURRENCE INTERVAL  
 ALLOWED EPA 13.6 @ WIND LOAD 90 MPH

Calculation Summary							
Label	CalcType	Units	Avg	Max	Min	Avg/Min	Max/Min
PAVED SURFACE READINGS	Illuminance	Fc	3.63	8.8	0.5	7.26	17.60
PROPERTY LINE READINGS	Illuminance	Fc	0.44	1.0	0.0	N.A.	N.A.

Luminaire Schedule									
Symbol	Qty	Label	Arrangement	LLF	Description	Lum. Watts	EPA	Mtg Height	Pole Type
	9	AB	SINGLE	0.900	RAR-2-480L-240-5K7-4-BC	226.9	0.607	21	SES-18-40-1-TA-GL-xx (4")
	10	F12G	SINGLE	0.900	LB6-10LDM-50K9GD	11.9		9.08 & 10.67	
	9	L2	SINGLE	0.900	RWSC-36L-5K-DO-U-PS	14.4		9.33 & 10.92	
	5	L2W	SINGLE	0.900	RWSC-36L-5K-DO-U-WH	14.4		9.33	

Regional Drawing  
 # 24-1290

1. THIS LIGHTING DESIGN IS BASED ON INFORMATION SUPPLIED BY OTHERS TO SECURITY LIGHTING SYSTEMS. SITE DETAILS PROVIDED HEREON ARE REPRODUCED ONLY AS A VISUALIZATION AID. FIELD DEVIATIONS MAY SIGNIFICANTLY AFFECT PREDICTED PERFORMANCE. PRIOR TO INSTALLATION, CRITICAL SITE INFORMATION (POLE LOCATIONS, ORIENTATION, MOUNTING HEIGHT, ETC.) SHOULD BE COORDINATED WITH THE CONTRACTOR AND/OR SPECIFIER RESPONSIBLE FOR THE PROJECT.  
 2. LUMINAIRE DATA IS TESTED TO INDUSTRY STANDARDS UNDER LABORATORY CONDITIONS. OPERATING VOLTAGE AND NORMAL MANUFACTURING TOLERANCES OF LAMP, BALLAST, AND LUMINAIRE MAY AFFECT FIELD RESULTS.  
 3. CONFORMANCE TO FACILITY CODE AND OTHER LOCAL REQUIREMENTS IS THE RESPONSIBILITY OF THE OWNER AND/OR THE OWNER'S REPRESENTATIVE.  
 4. THIS LAYOUT MAY NOT MEET TITLE 24 OR LOCAL ENERGY REQUIREMENTS. IF THIS LAYOUT NEEDS TO BE COMPLIANT WITH TITLE 24 OR OTHER ENERGY REQUIREMENTS, PLEASE CONSULT FACTORY WITH SPECIFIC DETAILS REGARDING PROJECT REQUIREMENTS SO THAT REVISIONS MAY BE MADE TO THE DRAWING.

**SECURITY LIGHTING™**  
 2100 Golf Road, Suite 400, Rolling Meadows, IL 60009  
 1-800-544-4444

UNLESS OTHERWISE SPECIFIED, ALL DIMENSIONS ARE IN INCHES  
 SCALE 1"=20' 0"  
 DRAWN BY: VH

POINT-BY-POINT FOOTCANDLE PLOT FOR  
 MCDONALD'S  
 3800 W SUNSHINE ST  
 SPRINGFIELD, MO

NATIONAL STORE NUMBER  
 40762

DATE: 2/21/2023  
 DRAWING NUMBER: EX50417-Rev1.AGI