

REVISIONS		
NO.	DATE	DESCRIPTION
-	-	-
-	-	-
-	-	-
-	-	-
-	-	-
-	-	-

SEAL

SEAL NOTE

PREPARED FOR  
**McDonald's USA LLC**

These drawings and specifications are the confidential and proprietary property of McDonald's USA, LLC and shall not be copied or reproduced without written authorization. The contract documents were prepared for use on this specific site in conjunction with its issue date and are not suitable for use on a different site or at a later time. Use of these drawings for reference or example on another project requires the services of properly licensed architects and engineers. Reproduction of the contract documents for reuse on another project is not authorized.

PROJECT DESCRIPTION  
**EXISTING CONDITIONS**

PROJECT LOCATION  
**McDonald's  
1610 E. PEORIA  
PAOLA, KS 66071**

SHEET TITLE  
**FLOOR PLAN**

SHEET MANAGEMENT  
PROJECT NO.: 015-0315  
DATE ISSUED: 09/17/2019  
DRAWN BY: RJ  
REVIEWED BY: JA

NATIONAL STORE #  
**26490**

SHEET NUMBER  
**A1.0**  
EX. FLOOR PLAN

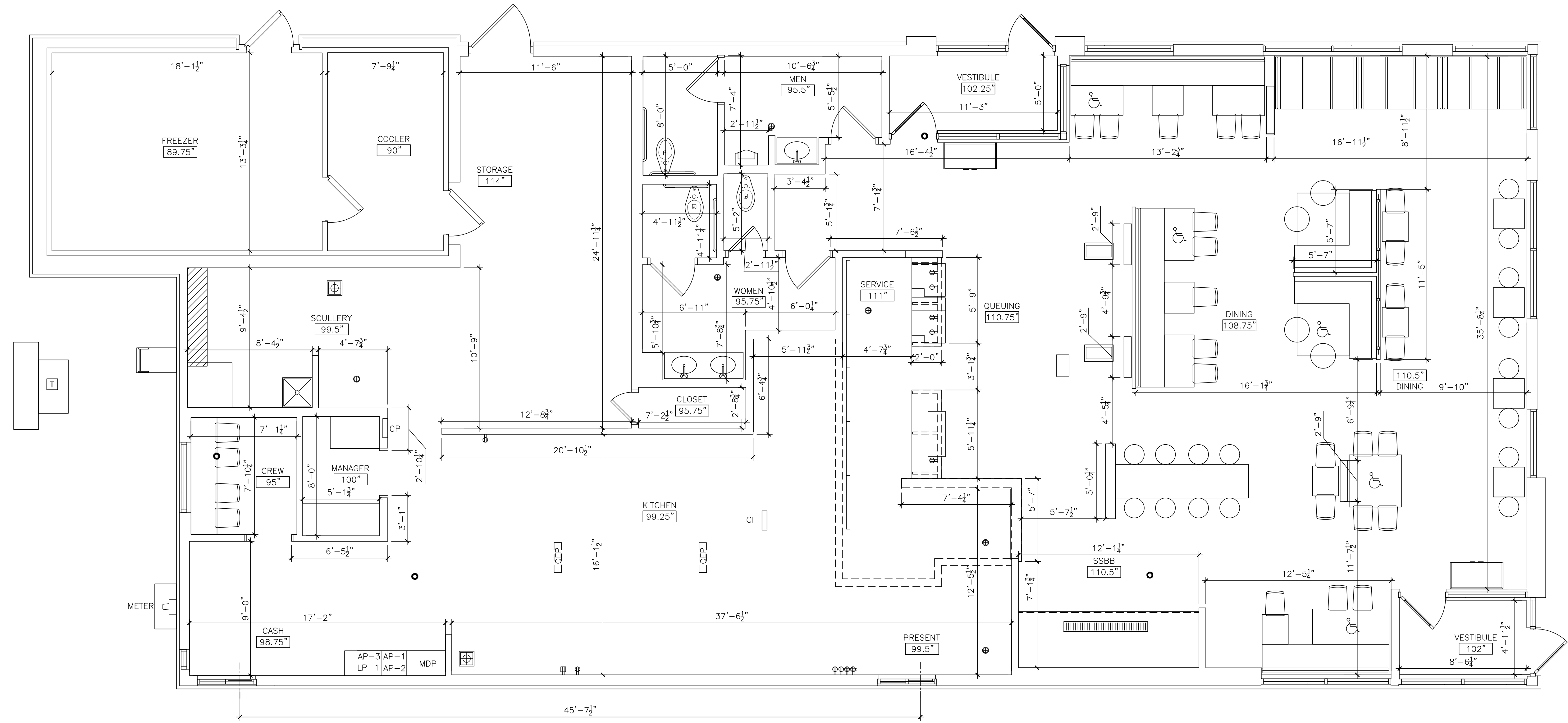

**1** EXISTING FLOOR PLAN - LEVEL 1  
SCALE: 1/4" = 1'-0"  
TOTAL SQ FT = 4,133  
TOTAL SEATING = 77

C:\Users\jaguilera\AppData\Local\Temp\AcPublish\_4680\015-0315 (26490) As Built CAD BKST.dwg September 17, 2019 - 5:34pm \$(GETVAR??)

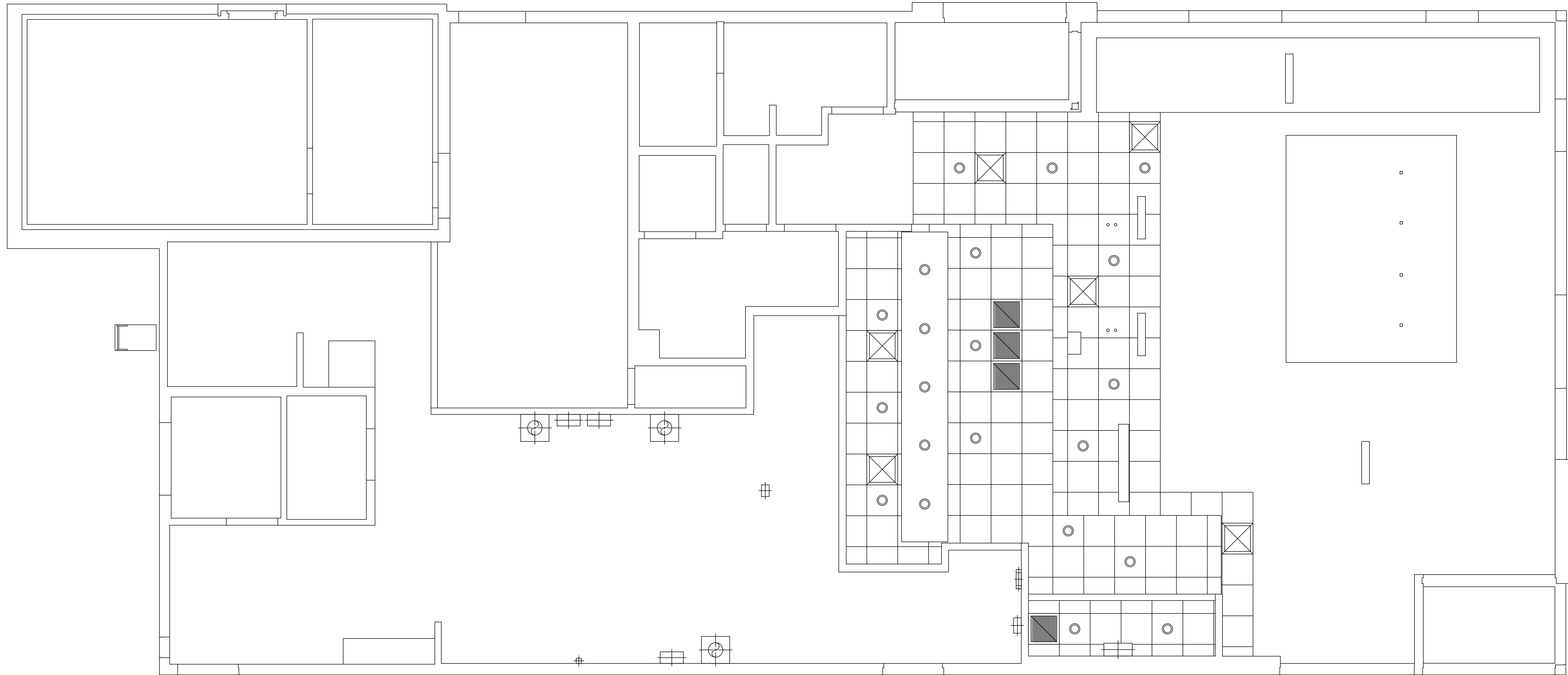

1 EXISTING REFLECTED CEILING PLAN  
 A1.1 SCALE: 1/4" = 1'-0"

REVISIONS		
NO.	DATE	DESCRIPTION
-	-	-
-	-	-
-	-	-
-	-	-
-	-	-
-	-	-

SEAL

SEAL NOTE

PREPARED FOR  
**McDonald's USA LLC**

These drawings and specifications are the confidential and proprietary property of McDonald's USA, LLC and shall not be copied or reproduced without written authorization. The contract documents were prepared for use on this specific site in conjunction with its issue date and are not suitable for use on a different site or at a later time. Use of these drawings for reference or example on another project requires the services of properly licensed architects and engineers. Reproduction of the contract documents for reuse on another project is not authorized.

PROJECT DESCRIPTION  
**EXISTING CONDITIONS**

PROJECT LOCATION  
**McDonald's  
 1610 E. PEORIA  
 PAOLA, KS 66071**

SHEET TITLE  
**REFLECTED  
 CEILING  
 PLAN**

SHEET MANAGEMENT  
 PROJECT NO.: 015-0315  
 DATE ISSUED: 09/17/2019  
 DRAWN BY: RJ  
 REVIEWED BY: JA

NATIONAL STORE #  
**26490**

SHEET NUMBER  
**A1.1**  
 EX. RCP

Submitted Type - AS-BUILT

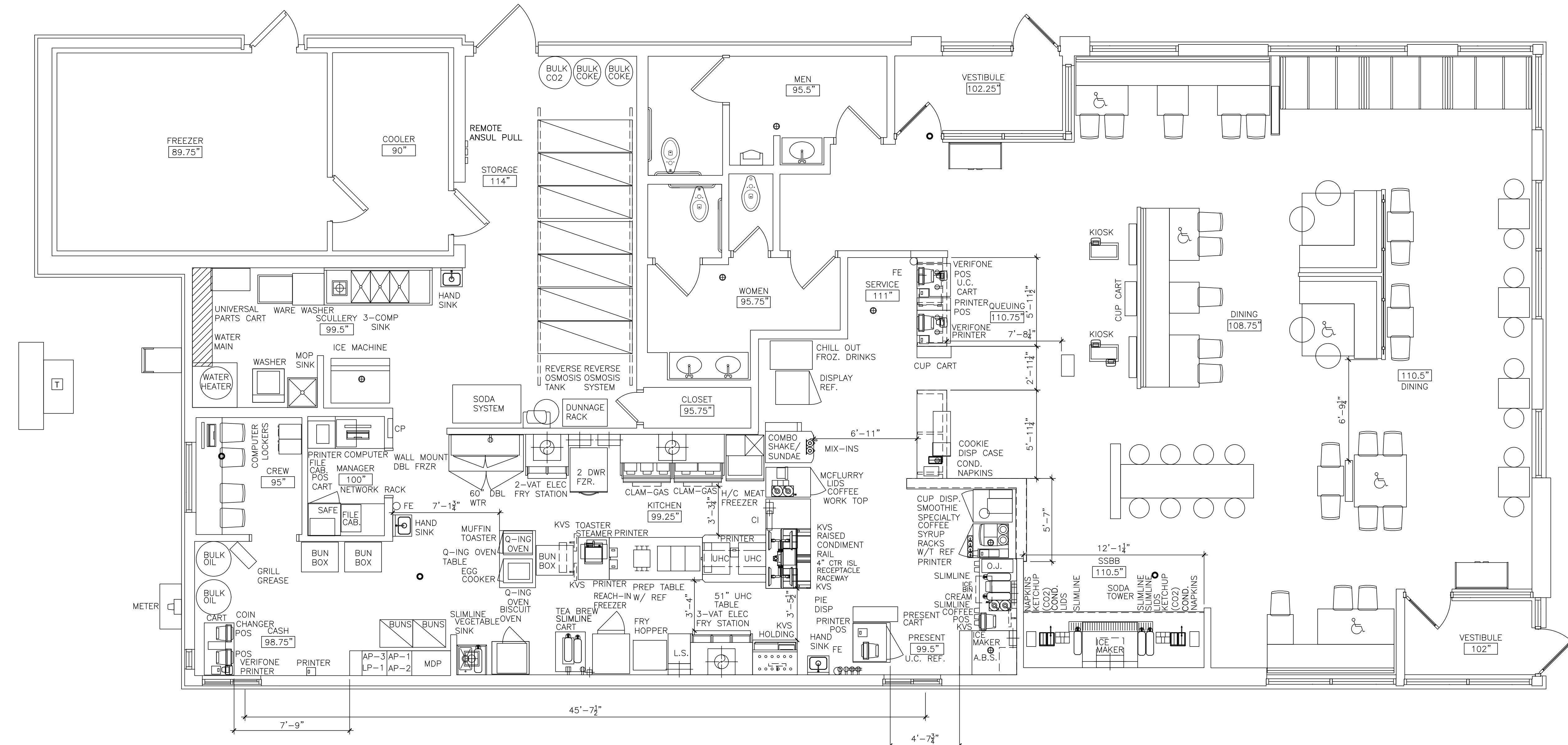

**1 EXISTING EQUIPMENT PLAN**  
K1.0 SCALE: 1/4" = 1'-0"

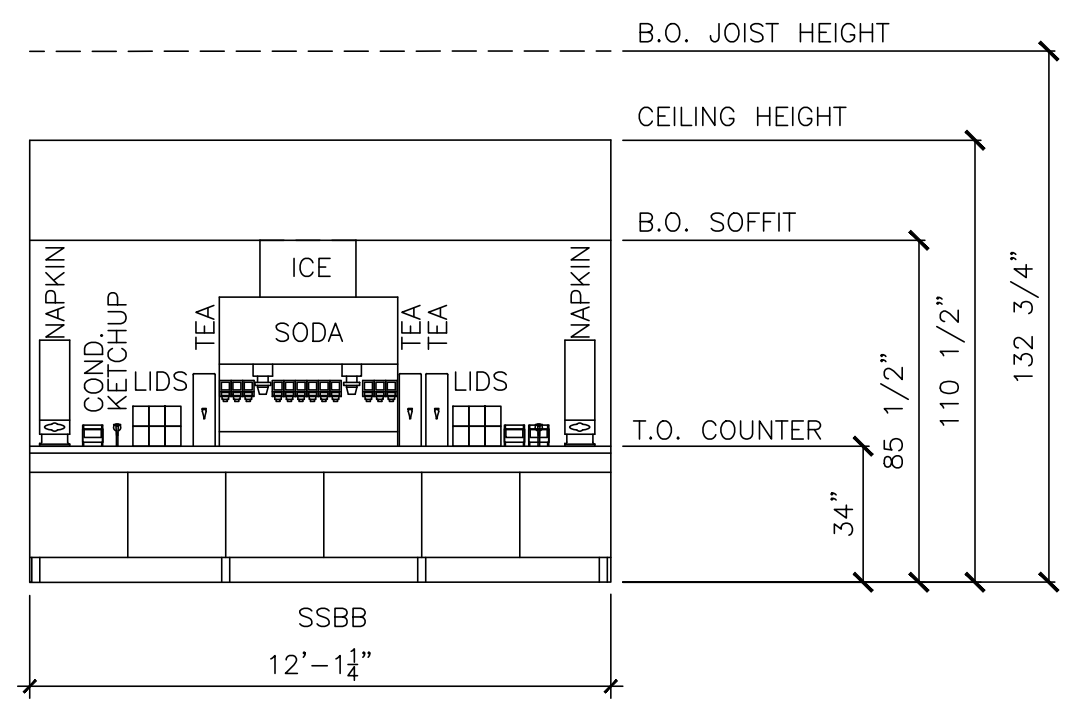

**2 EXISTING SSBB COUNTER ELEVATION**  
K1.0 SCALE: 1/4" = 1'-0"

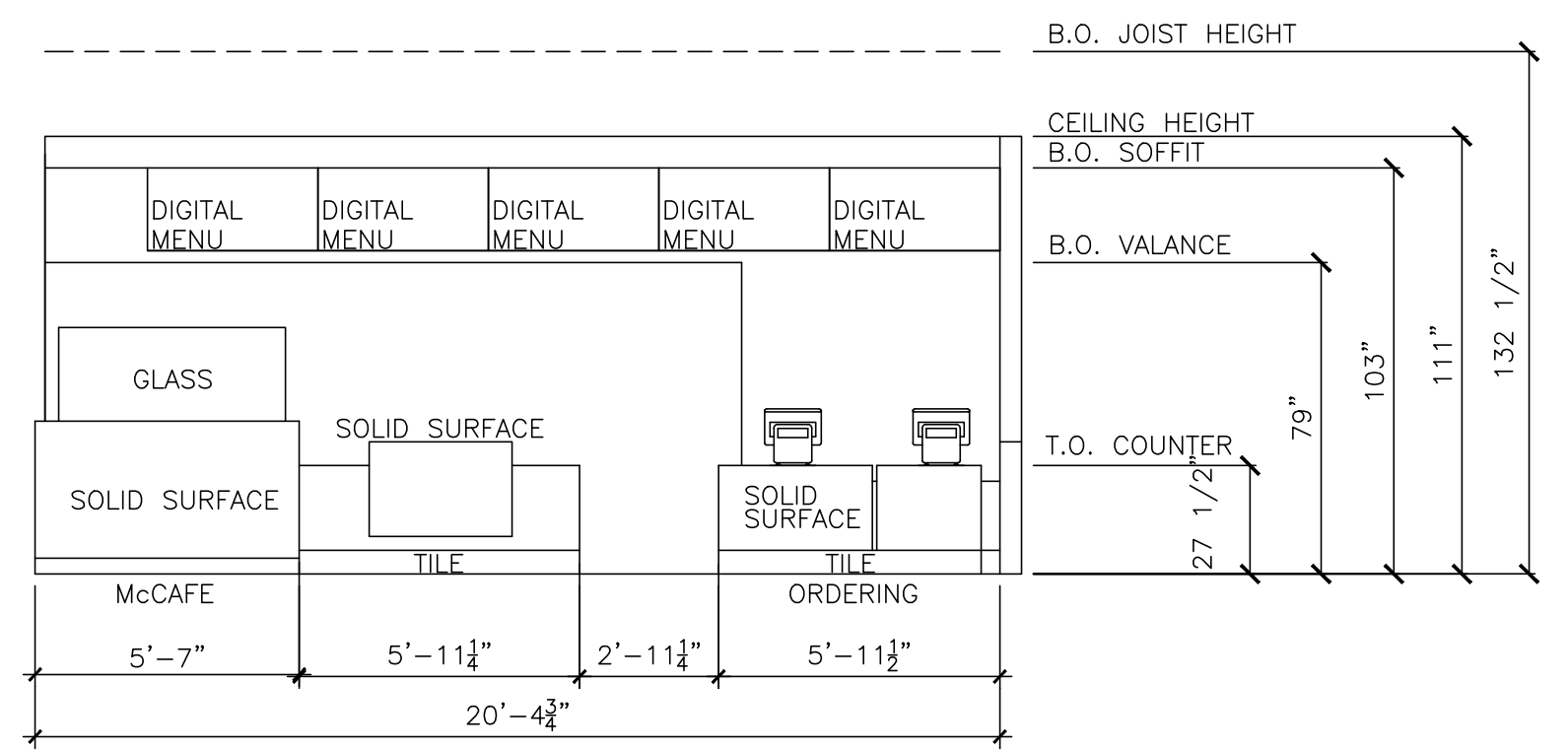

**3 EXISTING FRONT COUNTER ELEVATION**  
K1.0 SCALE: 1/4" = 1'-0"

REVISIONS	
NO.	DESCRIPTION

SEAL

SEAL NOTE

**PREPARED FOR**  
**McDonald's USA LLC**

These drawings and specifications are the confidential and proprietary property of McDonald's USA, LLC and shall not be copied or reproduced without written authorization. The contract documents were prepared for use on this specific site in conjunction with its issue date and are not suitable for use on a different site or at a later time. Use of these drawings for reference or example on another project requires the services of properly licensed architects and engineers. Reproduction of the contract documents for reuse on another project is not authorized.

**PROJECT DESCRIPTION**  
**EXISTING CONDITIONS**

**PROJECT LOCATION**  
**McDonald's**  
**1610 E. PEORIA**  
**PAOLA, KS 66071**

**SHEET TITLE**  
**KITCHEN**  
**EQUIPMENT PLAN**

**SHEET MANAGEMENT**  
PROJECT NO.: 015-0315  
DATE ISSUED: 09/17/2019  
DRAWN BY: RJ  
REVIEWED BY: JA

**NATIONAL STORE #**  
**26490**

**SHEET NUMBER**  
**K1.0**  
EX. EQUIPMENT PLAN